

Montgomery Early College

The Early College Defined

- * Original Intent:
 - * Focus on young people for whom the transition into postsecondary education is problematic.
 - * Targets students who are;
 - * At risk of dropping out of high school,
 - * First-generation college students, and/or
 - * Students who would benefit from accelerated learning opportunities.
 - * (CIHS@dpi.nc.gov) ([Jobs for the Future - EC History](#))
- * High school located on campus of community college or university.
- * Typically grades 9 – 13
- * Complete high school requirements and two years of college within five years.
- * No charge to the family.

Brief History of Early College Program

- * Idea for early college started in 2002.
- * Came out of a conversation educational leaders within the state.
- * Small group of retired superintendents
 - * (What if we could change the high school experience for students in the state)
 - * NC New Schools (Bill and Melinda Gates Foundation)
 - * Jobs for the Future
 - * Leadership Group for the Carolinas
- * Developed school change coaches
 - * Developed a common instructional framework
 - * Worked with school systems for a planning year and first year of operation to develop new innovative high schools.

History (Continued)

- * Today – General Assembly Oversees Funding
 - * Creating a new school
- * Legislation
 - * The Innovative Education Initiatives Act (SL 2003-277, Senate Bill 656)
 - * Cooperative Innovative High School Programs statute (§ 115C-238.50-.55)
- * Currently, NC has over 100 Cooperative Innovative High Schools, including 80 funded partnerships.
- * LEAs interested in creating a Cooperative Innovative High School must apply in partnership with an Institution of Higher Education.

Benefits to MCC

- * Attracting current and future students
 - * Students who would not have attended otherwise
 - * Students who complete part of a degree
- * More likely to stay in the college and community
 - * Students see educational opportunities in Montgomery County
 - * Train for local careers
- * Expands funding for MCC
 - * Increased enrollment
 - * Utilizes excess course capacity

Benefits to MCS

- * Expands opportunities for students
- * Students earn college credit while still in high school
- * At risk students don't get lost in the system
- * Allows MCS to market to wider audience of students
- * Allows MCS to provide more rigorous curriculum to combat “charter school” issue

Benefits to Montgomery County

- * Aligns to business needs for a more technically skilled and educated workforce
- * Professional and technical curriculum focused on these much sought after and needed skills for ALL enrolled students
- * Allows for expansion of internships and work-based/field-learning opportunities – Train from within instead of looking without...
- * Allows for specific training on industry standard equipment
- * Education with a future career focus leads to fewer dropouts – easing the burden on social services and criminal justice system

Advantages to Students who Attend an Early College

- * Seamless transition
 - * Course credit counts for both high school and college credit
 - * Eliminates course duplication
 - * High school and college programs are integrated
- * Free college education
- * Smaller more personal environment
 - * Most courses will enroll 10 – 20 students
- * Higher graduation rate
 - * 90% vs 78% nationally
- * Own school culture
 - * Students can personalize their environment

Design Plans

- * Working on architectural plan
- * Aligned to discussion of USDA funding

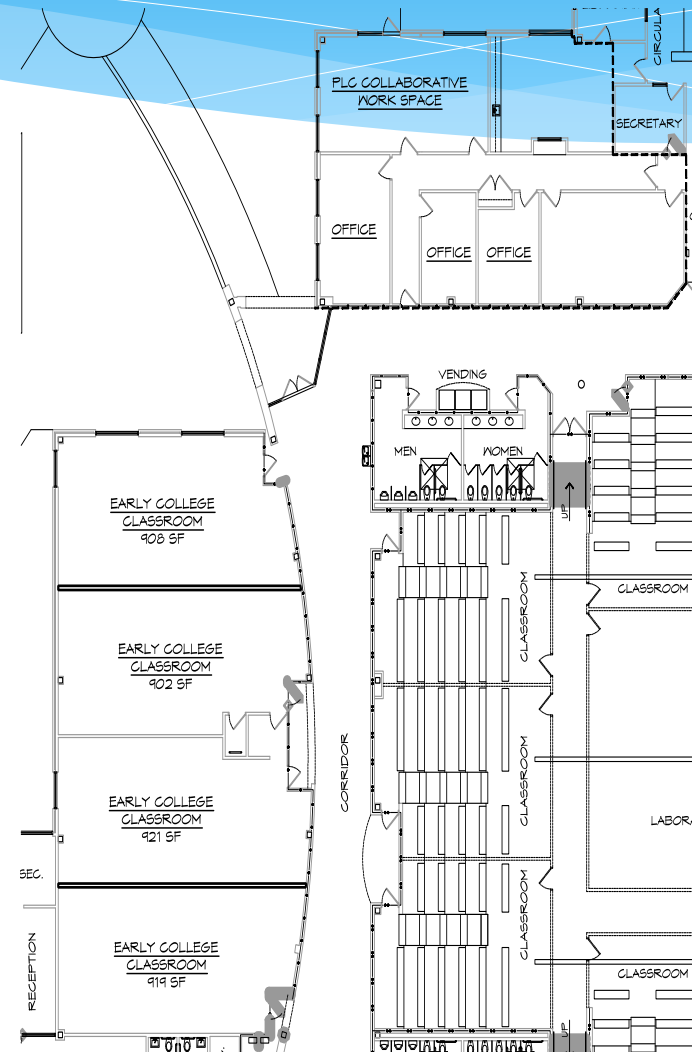

Coursework

MCS CTE Early College Pathways.xlsx

3/19/16, 7:57 PM

Freshmen Year Fall	Freshmen Year Spring	
Health & PE	Honors English I	
Honors Earth & Environmental	CIS 110	
Foundation of Math I	Math I	
Honors Civics and Econ	PLTW Intro to Engineering	
Sophomore Year Fall	Sophomore Year Spring	
Honors English II	Art 111/Mus 110/Com 231	
Honors Math II	Honors Math III	
Bio 111	Bio 112	Satisfies 1 HS Science
PLTW Principles of Eng	Elective	Electives in HS years may consist of CTE or College
Junior Year Fall	Junior Year Spring	
Eng 111	Eng 112	
Mat 171	Mat 172	Satisfies HS 4th Math
His 111	His 112	Satisfies World History
Chem 151	Chem 152	Satisfies 1 HS Science
PLTW Civil Engineering and Arc.	Psy 150 or Com 231	
Senior Year Fall	Senior Year Spring	
World Language I	World Language II	
Eng 231	Eng IV/AP Eng	ENG 111,112,231 Satisfies Eng III
Mat 271	PLTW Computer Integrated Manufacturing	
His 131	His 132	Satisfies American I, II
Eco 251- Principles of Micro Econ	EGR 150- Intro to Engineering	Possible articulation agreement with EGR 150 and

Criteria for Participation in an Early College

- * First generation college students or based upon student need
- * Declared major
- * Reflects the make-up of the school district
- * Enrollment must focus on high school mission
 - * i.e. STEM oriented early college
- * Technical abilities (Past performance in math and science)
- * Lottery system will be developed to handle an anticipated influx of applications each year

Tentative Timeline

- | | |
|---------------------|-------------------------|
| * April 2016 | Submit letter of intent |
| * May – August | Application development |
| * September | Submit application |
| * September – March | Approval process |
| * Summer | Final approval |
| * Fall 2017 | Early College opening |

Other Questions

- * Would one high school change the Early College Concept?
 - * Would not negatively affect Early College
 - * Would strengthen it
 - * Early college would be an independent high school
 - * Early college would be a collaborative entity between MCC and MCS, with shared spaces and equipment... only strengthening the current partnership and helping both organizations while ultimately benefitting the future of Montgomery County
- * So, what are the benefits of centralization and consolidation?

Benefits of a Central High School

- * More diverse offerings to include a wider array of CCP Courses – More students in CCP = more offerings
- * No program duplication means there will be more ample funding to maintain the highest quality of industry standard equipment
- * Increased access to clubs, student organizations, and competitions
- * Increased access to internships, apprenticeships, job-shadowing, and cooperative learning opportunities
- * Wider variety of courses for OCS students

Benefits of Central HS – Cont.'

- * Better coordination for student services and guidance
- * Centralized Band, Art, Drama, and Chorus Programs
- * Increased access to historically low enrollment courses that may not make in our traditional program
- * Consolidations would save the County approximately \$28,000,000 over the next 30 years - \$15m in maintenance costs and \$13m in personnel
- * Will strengthen relationship between MCS and MCC
- * A constant, steady stream of possible future students driving by MCC every day

Downloaded from <http://ajphaphysiol.physiology.org/> by guest on September 11, 2012



PINNACLE ARCHITECTURE
PROFESSIONAL ASSOCIATION
P.O. BOX 187, 630 TEAM ROAD, SUITE 200
MATTHEWS, NORTH CAROLINA 28106
PH: (704) 847-9851 F: (704) 847-9852

EMS Site Plan

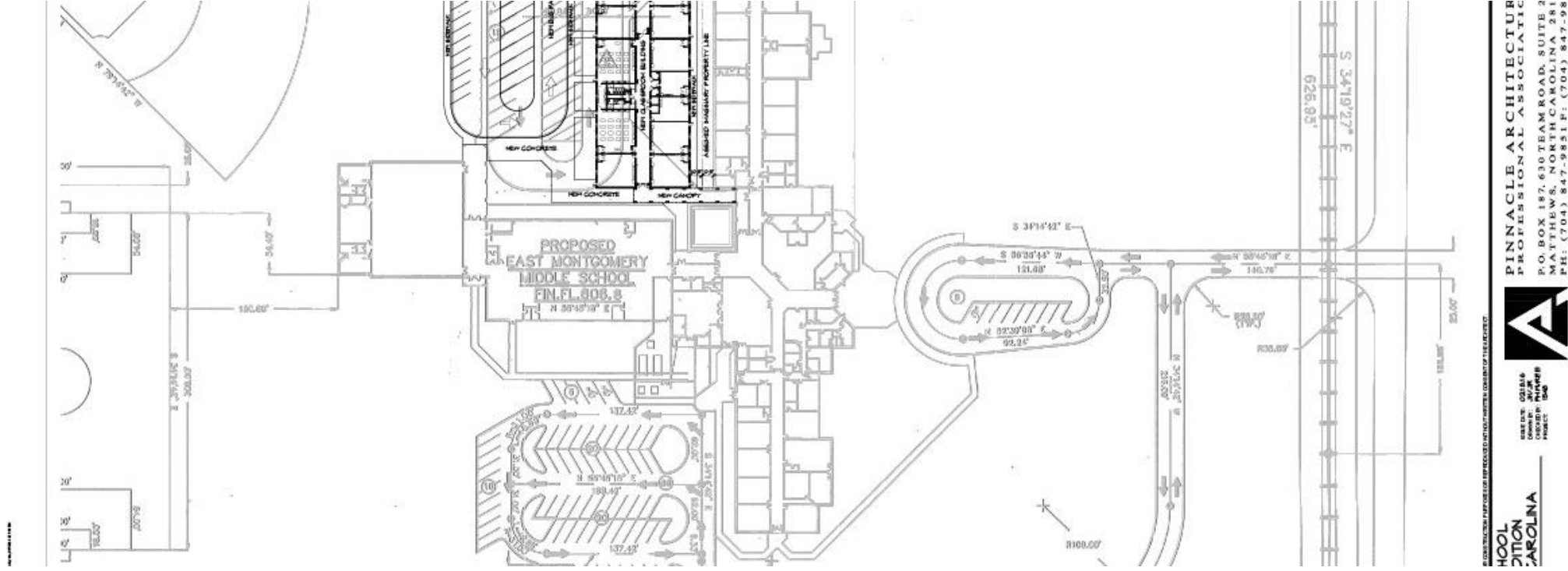



MONTGOMERY COMMUNITY COLLEGE

1011 PAGE ST. • Troy, NC 27371 • TELEPHONE: (910) 576-MCCC (6222) • FAX: (910) 576-2176



March 24, 2016

Dr. Dale Ellis
Montgomery County Schools
P.O. Box 427
Troy, NC 27371

Dear Dr. Ellis:

Montgomery Community College appreciated the opportunity to present our budget and future plans to the Board of County Commissioners at their retreat on March 22. During the education segment County Manager, Matthew Woodard, inquired about the opinion of the Montgomery Community College Board of Trustees regarding a new central high school. The Board of Trustees, prompted by that question held a discussion on the consolidation to a central high school on their meeting on March 23, 2016. The position of the Montgomery Community College Board of Trustees is that the decision to consolidate the two high schools into one new central location is the responsibility of the Montgomery County School Board in cooperation with the Superintendent of Schools and his staff. The funding of a new high school is the responsibility of the Board of County Commissioners in cooperation with the County Manager and his staff.

The trustees view a new central high school located near the college campus as positive for Montgomery Community College and high school students. It will facilitate the growth of current co-operative programs. The Career and College Promise program open to high school students would benefit by being able to offer more courses on campus with the elimination of transportation issues for students attending classes at Montgomery Community College. The Early College High School currently projected to open in Fall 2017 would benefit with proximity to sports and other activities at the central high school. Students at the new high school will become familiar with the campus and activities at Montgomery Community College—an encouragement to continue on to a college education.

If the Montgomery County School Board makes the decision to proceed with a new central high school, the Board of Trustees of Montgomery Community College resolves to support a new central high school for Montgomery County.

Sincerely,

Claudia B. Bulthuis
Chairman
Montgomery Community College Board of Trustees